

RFB UC17-142C
 CONTRACT DRAWINGS FOR
 CONTRACT NO. 2016-00000427
**RESTORATION OF THREE SEGMENTS OF THE
 ULSTER & DELAWARE RAILROAD CORRIDOR**

IN THE TOWNS OF OLIVE & SHANDAKEN
 ULSTER COUNTY, NEW YORK

PREPARED FOR:
 COUNTY OF ULSTER
 244 FAIR STREET
 KINGSTON, NY 12401

FEBRUARY 2017

PREPARED BY:
PEAK
 ENGINEERING
 3761 Main Street - PO Box 540
 Poughkeepsie, NY 12504
 (845) 887-4500

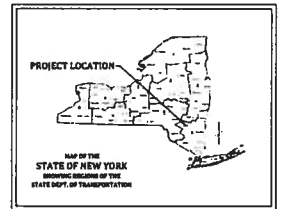

DRAWING INDEX			
DRAWING NO.	DATE	BY / REVISED BY	DESCRIPTION
1			LOCATION MAP & MAP OF TOWNSHIPS
2			1:5000 SCALE PLAN OF SEGMENTS 1, 2 & 3
3			CONSTRUCTION SPECIFICATIONS & SOIL EROSION AND STABILIZATION DETAILS
4			SOIL EROSION AND STABILIZATION CONTROL PLAN
5			CONSTRUCTION PLAN AND PROFILE
6			1:5000 SCALE PLAN OF SEGMENTS 1, 2 & 3
7			1:5000 SCALE PLAN AND PROFILE
8			1:5000 SCALE CONSTRUCTION PLAN, EROSION CONTROL PLAN & PROFILE
9			1:5000 SCALE CONSTRUCTION PLAN

11. SEGMENT 1 - MILE POST 23.3 THROUGH AT 42.026M, 74.277W
 STREAM DISTURBANCE & FLOODED PLAIN DEVELOPMENT PERMIT REQUIRED
 12. SEGMENT 2 - MILE POST 22.30 THROUGH AT 42.026M, 74.277W
 13. SEGMENT 3 - MILE POST 21.9 - 22.0 DAMAGED RAILBED AT 42.026M, 74.277W

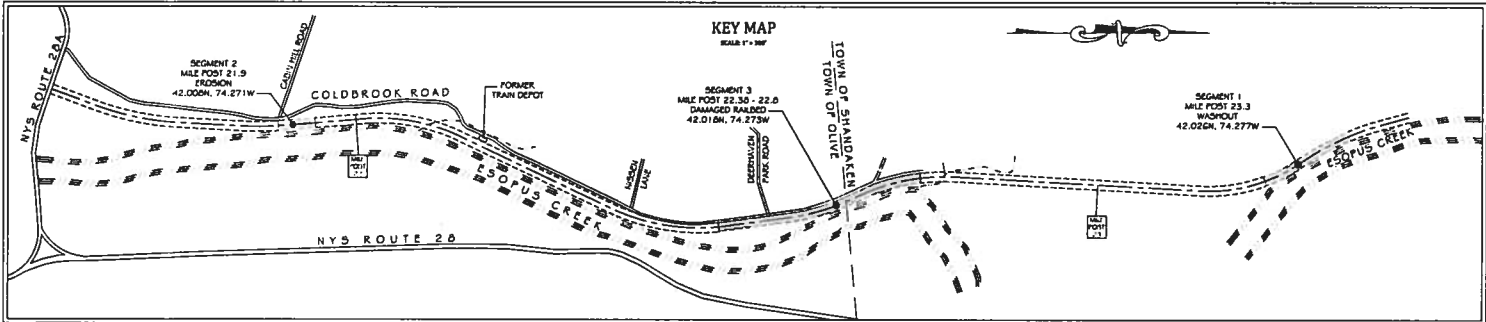

ALL WORK COMPLETED UNDER THIS CONTRACT IS TO BE IN ACCORDANCE WITH THE SPECIFICATIONS AND STANDARDS OF THE TRANSPORTATION DESIGN SPECIFICATIONS (TRANSDESIGN) OF THE STATE OF NEW YORK, AND THE FEDERAL SPECIFICATIONS FOR ROAD AND BRIDGE CONSTRUCTION, AND THE FEDERAL SPECIFICATIONS FOR HIGHWAY BRIDGE CONSTRUCTION, AND THE FEDERAL SPECIFICATIONS FOR HIGHWAY BRIDGE CONSTRUCTION, AND THE FEDERAL SPECIFICATIONS FOR HIGHWAY BRIDGE CONSTRUCTION.

PROJECT #16244

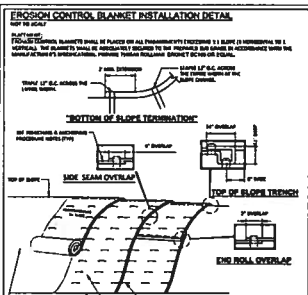
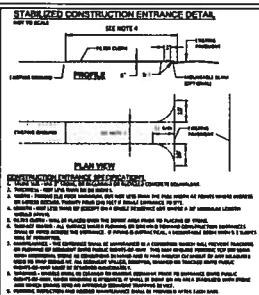

RIP-RAP OUTLET PROTECTION DETAIL

CROSS SECTION

STONE RIP-RAP SIZING REQUIREMENT

STONE SIZE	MINIMUM PERCENTAGE	MINIMUM PERCENTAGE	MINIMUM PERCENTAGE	MINIMUM PERCENTAGE	MINIMUM PERCENTAGE
1/4" - 3/8"	10	10	10	10	10
3/8" - 1/2"	10	10	10	10	10
1/2" - 3/4"	10	10	10	10	10
3/4" - 1"	10	10	10	10	10
1" - 1 1/4"	10	10	10	10	10
1 1/4" - 1 1/2"	10	10	10	10	10
1 1/2" - 1 3/4"	10	10	10	10	10
1 3/4" - 2"	10	10	10	10	10
2" - 2 1/4"	10	10	10	10	10
2 1/4" - 2 1/2"	10	10	10	10	10
2 1/2" - 2 3/4"	10	10	10	10	10
2 3/4" - 3"	10	10	10	10	10
3" - 3 1/4"	10	10	10	10	10
3 1/4" - 3 1/2"	10	10	10	10	10
3 1/2" - 3 3/4"	10	10	10	10	10
3 3/4" - 4"	10	10	10	10	10
4" - 4 1/4"	10	10	10	10	10
4 1/4" - 4 1/2"	10	10	10	10	10
4 1/2" - 4 3/4"	10	10	10	10	10
4 3/4" - 5"	10	10	10	10	10
5" - 5 1/4"	10	10	10	10	10
5 1/4" - 5 1/2"	10	10	10	10	10
5 1/2" - 5 3/4"	10	10	10	10	10
5 3/4" - 6"	10	10	10	10	10
6" - 6 1/4"	10	10	10	10	10
6 1/4" - 6 1/2"	10	10	10	10	10
6 1/2" - 6 3/4"	10	10	10	10	10
6 3/4" - 7"	10	10	10	10	10
7" - 7 1/4"	10	10	10	10	10
7 1/4" - 7 1/2"	10	10	10	10	10
7 1/2" - 7 3/4"	10	10	10	10	10
7 3/4" - 8"	10	10	10	10	10
8" - 8 1/4"	10	10	10	10	10
8 1/4" - 8 1/2"	10	10	10	10	10
8 1/2" - 8 3/4"	10	10	10	10	10
8 3/4" - 9"	10	10	10	10	10
9" - 9 1/4"	10	10	10	10	10
9 1/4" - 9 1/2"	10	10	10	10	10
9 1/2" - 9 3/4"	10	10	10	10	10
9 3/4" - 10"	10	10	10	10	10

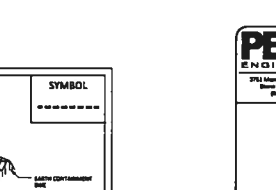
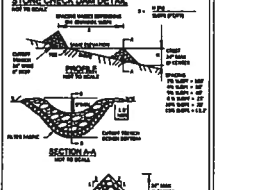
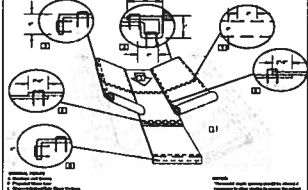
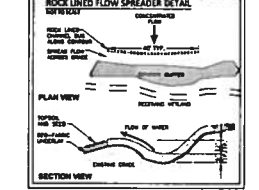
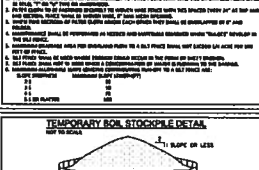
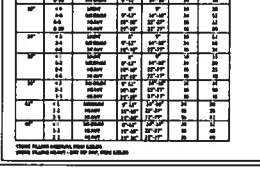
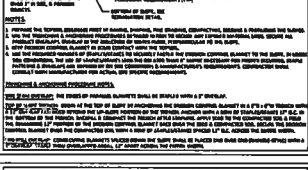
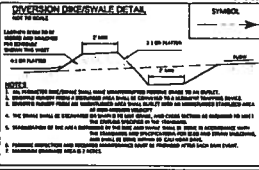
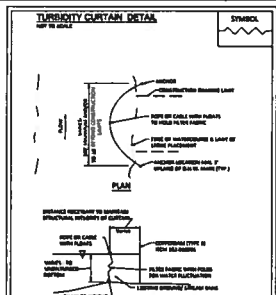
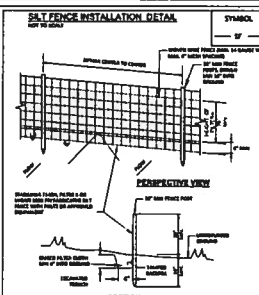

PEAK
ENGINEERING

2711 Main Street, P.O. Box 100
Brewster, NY 13804
(607) 461-4000

Client: County of Herk
244 Four Street
Kingston, NY 12401

Project: US1201/1217
1000 Railroad Corridor

Project # 1024

Drawn: [Name]
Checked: [Name]
Date: 3/23/2017

Scale: As Shown
Design: EAD
Check: EAD
Sheet # 4

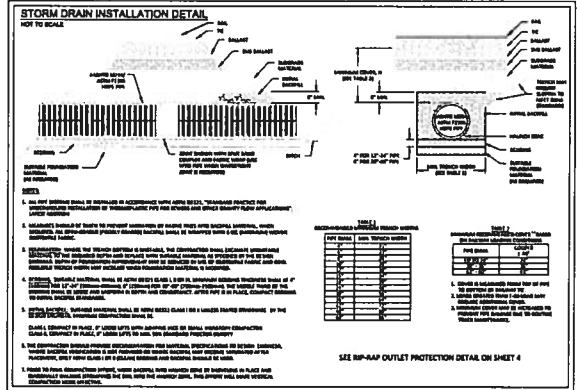
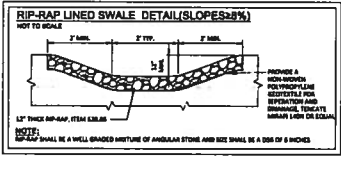
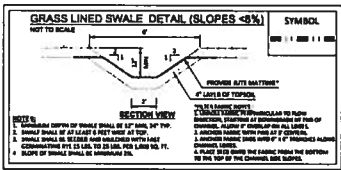
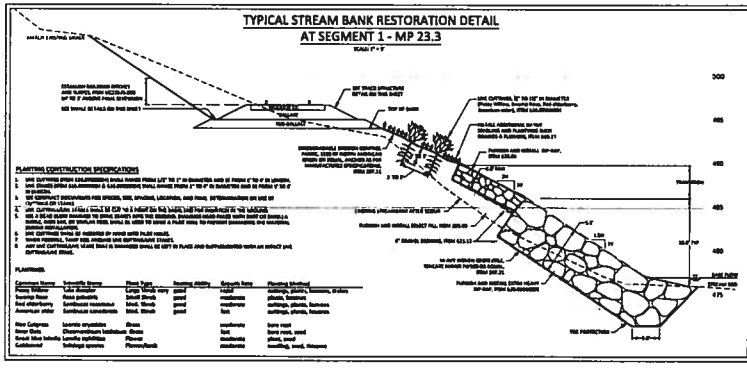
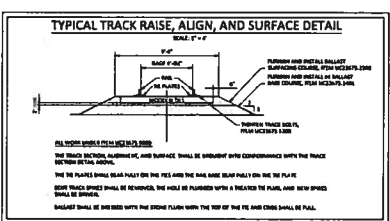
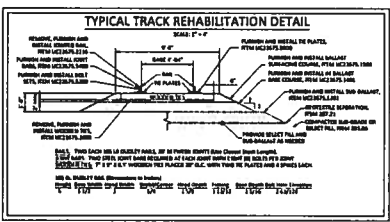
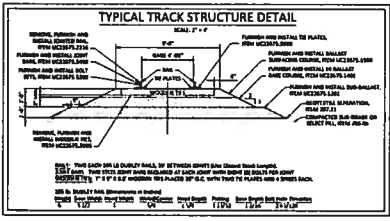

PEAK ENGINEERING
 214 Four Street
 Kingston, NY 12401
 518-537-1234

Client: County of Ulster
 214 Four Street
 Kingston, NY 12401

Project: LC2016-17
 S&D Railroad Corridor

Project # 1624

Site: Site Details

Revision:

Drawn By: NDC

Checked By: S&D

Sheet # 5

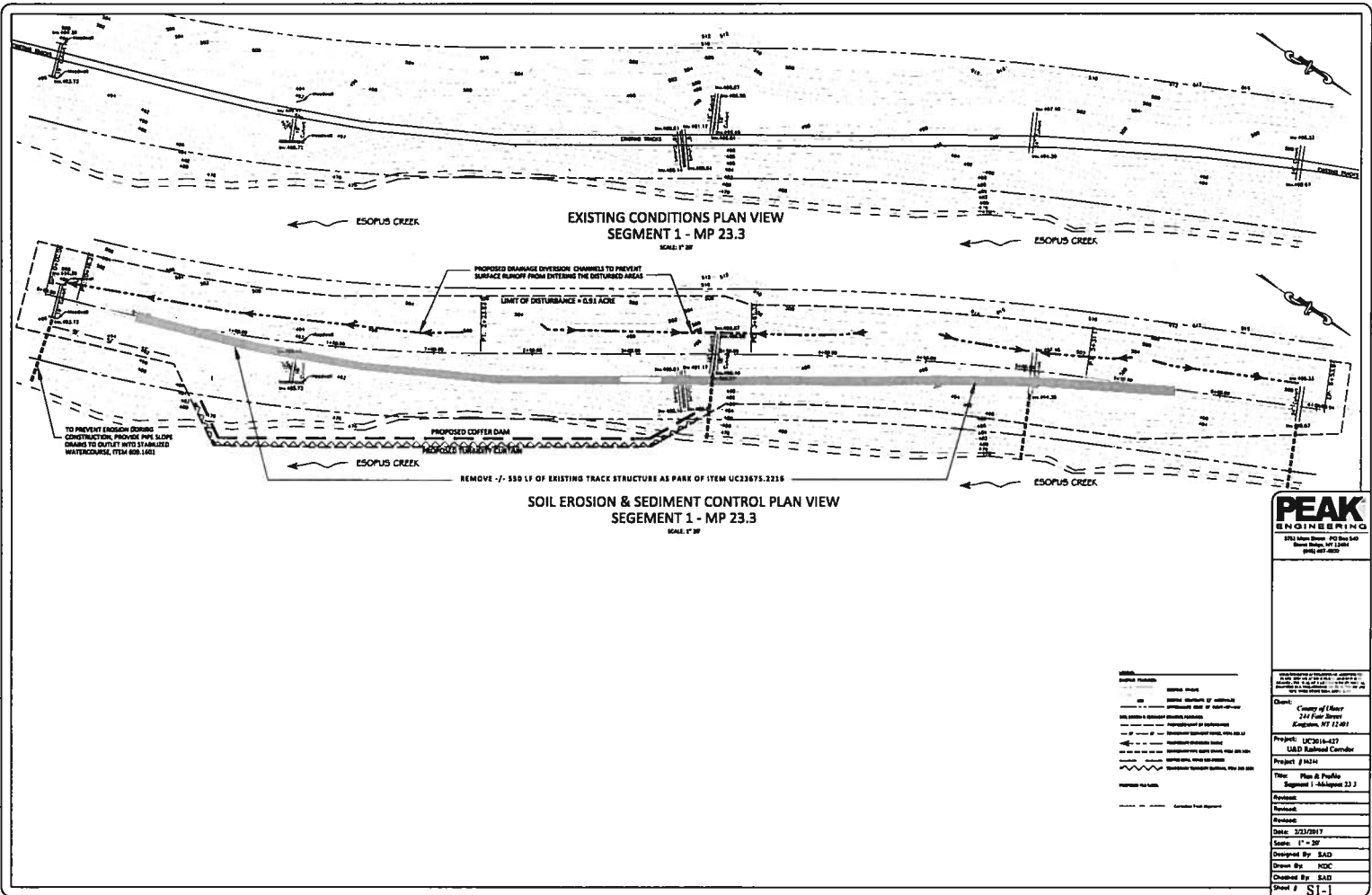

PEAK
 25 PA 03 14 02 03 04 05 06 07 08 09 10 11 12 13 14 15 16 17 18 19 20 21 22 23 24 25
 1911 Lakeshore Drive, P.O. Box 540
 Morris Plains, NJ 07960
 908-467-4000

Client: **County of Ulster**
 241 Four Street
 Kingston, NY 12401

Project: **UC23675.2216**
 U&D Railroad Corridor

Project # **6424**

Title: **Plan & Profile**
Segment 1 - Subsegment 23 J

Drawn By: **BAID**
 Checked By: **BAID**
 Sheet # **SI-1**

CURVE #1	CURVE #2
PC 201+75.00	PC 201+75.00
PT 201+75.00	PT 201+75.00
PI 201+75.00	PI 201+75.00
EA 201+75.00	EA 201+75.00
EB 201+75.00	EB 201+75.00
EC 201+75.00	EC 201+75.00
ED 201+75.00	ED 201+75.00
EE 201+75.00	EE 201+75.00
EF 201+75.00	EF 201+75.00
EG 201+75.00	EG 201+75.00
EH 201+75.00	EH 201+75.00
EI 201+75.00	EI 201+75.00
EJ 201+75.00	EJ 201+75.00
EK 201+75.00	EK 201+75.00
EL 201+75.00	EL 201+75.00
EM 201+75.00	EM 201+75.00
EN 201+75.00	EN 201+75.00
EO 201+75.00	EO 201+75.00
EP 201+75.00	EP 201+75.00
EQ 201+75.00	EQ 201+75.00
ER 201+75.00	ER 201+75.00
ES 201+75.00	ES 201+75.00
ET 201+75.00	ET 201+75.00
EU 201+75.00	EU 201+75.00
EV 201+75.00	EV 201+75.00
EW 201+75.00	EW 201+75.00
EX 201+75.00	EX 201+75.00
EY 201+75.00	EY 201+75.00
EZ 201+75.00	EZ 201+75.00

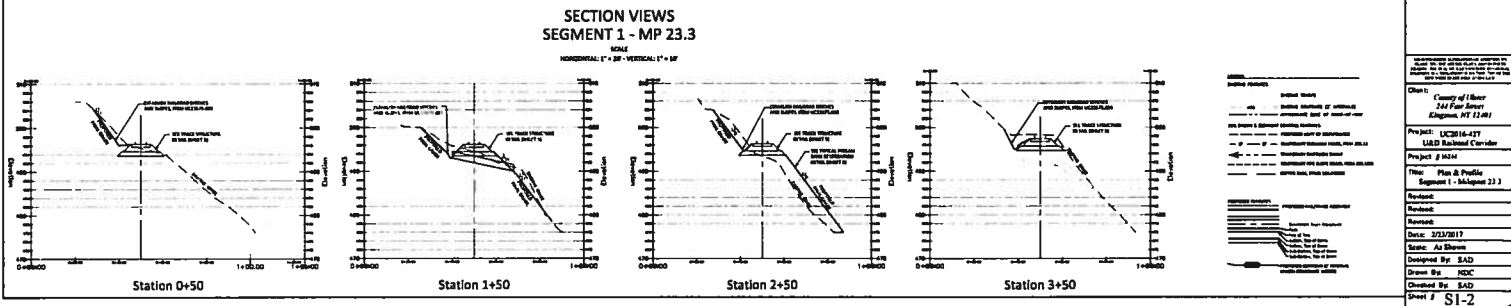
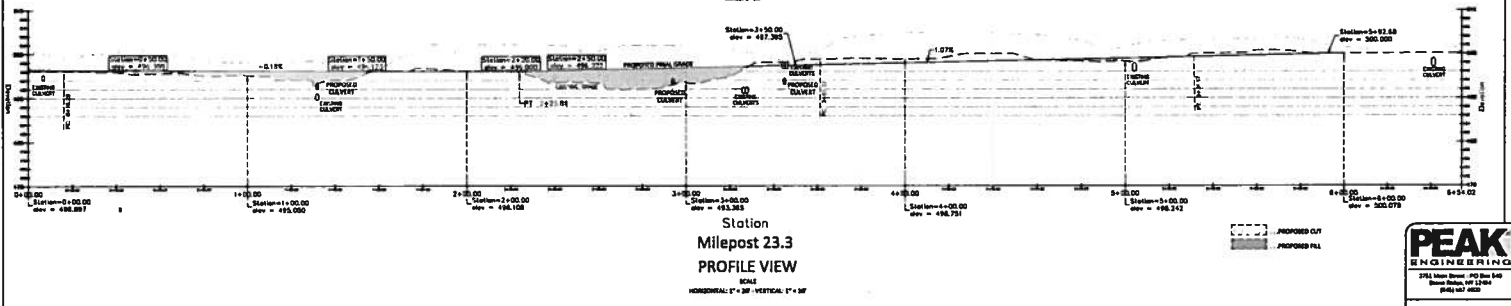
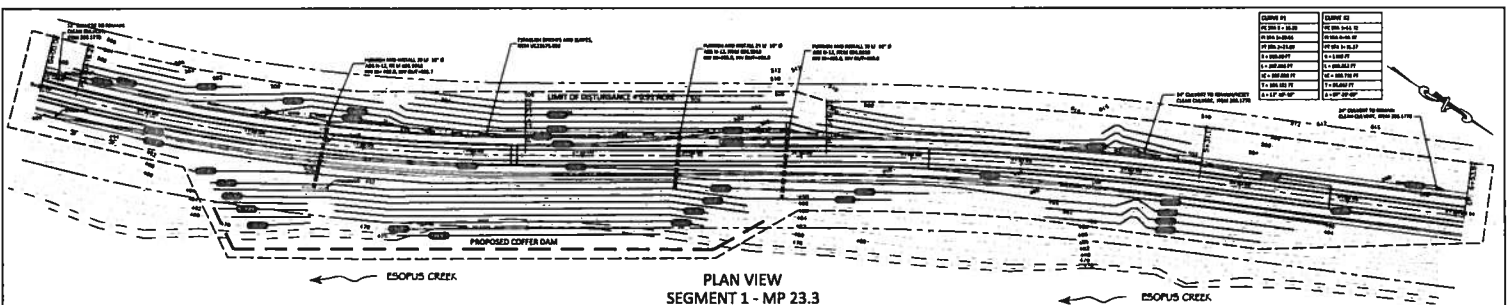

PEAK ENGINEERS
276 Main Street, P.O. Box 540
Barnesville, GA 30414
(706) 867-4822

Client: County of Ulster
344 Four Street
Kingston, NY 12401

Project: LC2016-077
LARD Railroad Corridor
Project # 1624

Title: Plan & Profile
Segment 1 - Milepost 23.3

Revised: _____
Revised: _____
Revised: _____
Date: 3/23/2017
Drawn: As Shown
Designed By: EAD
Drawn By: HDC
Checked By: EAD
Sheet # **S1-2**

**EXISTING CONDITIONS
SEGMENT 2 - MILEPOST 21.9**
SCALE: 1" = 50'

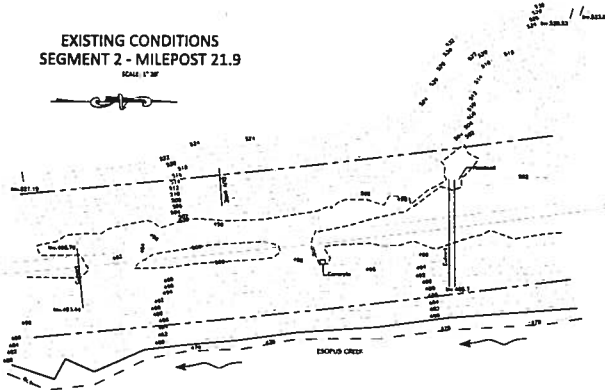

**SOIL EROSION & SEDIMENT CONTROL
SEGMENT 2 - MILEPOST 21.9**
SCALE: 1" = 50'

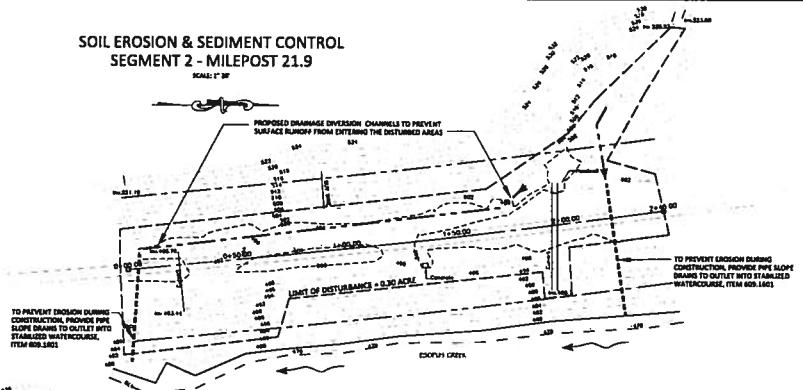

**GRADING PLAN
SEGMENT 2 - MILEPOST 21.9**
SCALE: 1" = 50'

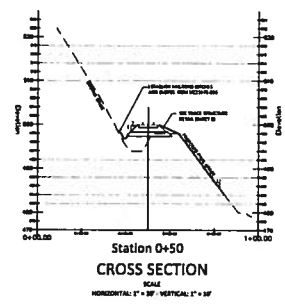
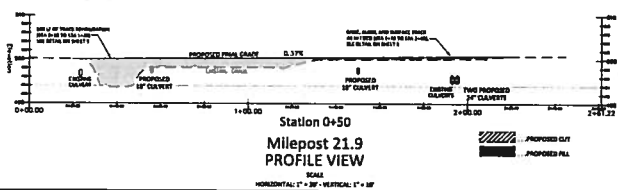
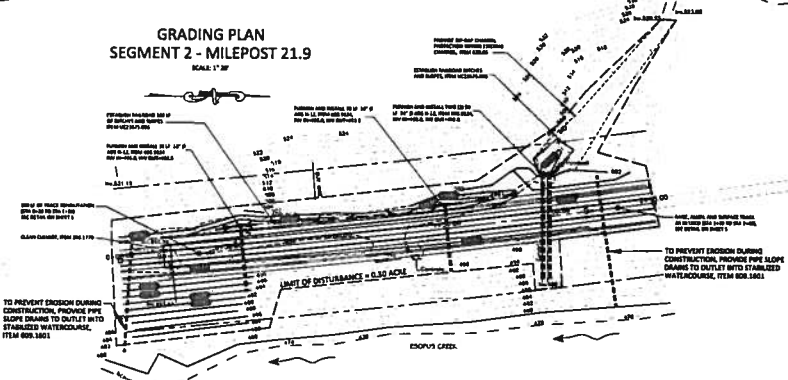

SYMBOLS	
(Symbol)	Existing Road
(Symbol)	Proposed Road
(Symbol)	Proposed 18\"/>

PEAK ENGINEERING
2764 Lake Street, #10 East Ave
Saugerties, NY 12480
(845) 681-4000

Client: County of Ulster
244 Fair Street
Saugerties, NY 12480

Project: I-84/28-027
I-84/D Railroad Rehabilitation

Project # 14304

Title: Plans & Profile
Segment 2 - Milepost 21.9

Drawn: [Blank]
Checked: [Blank]
Date: 3/23/2017
Scale: As Shown
Designed By: SADD
Drawn By: NDC
Checked By: SADD
Sheet # S2-1

